

CERTIFICATE OF LOCATION OF GOVERNMENT CORNER

EAST QUARTER Corner of Section 17, Township 105, Range 43, 5TH P.M.

STATE OF MINNESOTA, County of MURRAY

At the corner location shown on the sketch:

On 10-21-2008 found a 6" ROUND CONCRETE MONUMENT
DATE

left monument as found, lowered monument, removed monument (explain)

On 10-21-2008 placed a 5/8" IRONS WITH SEAL #43844 ON NORTH AND SOUTH
DATE SIDES OF MONUMENT

SKETCH OF REFERENCE TIES

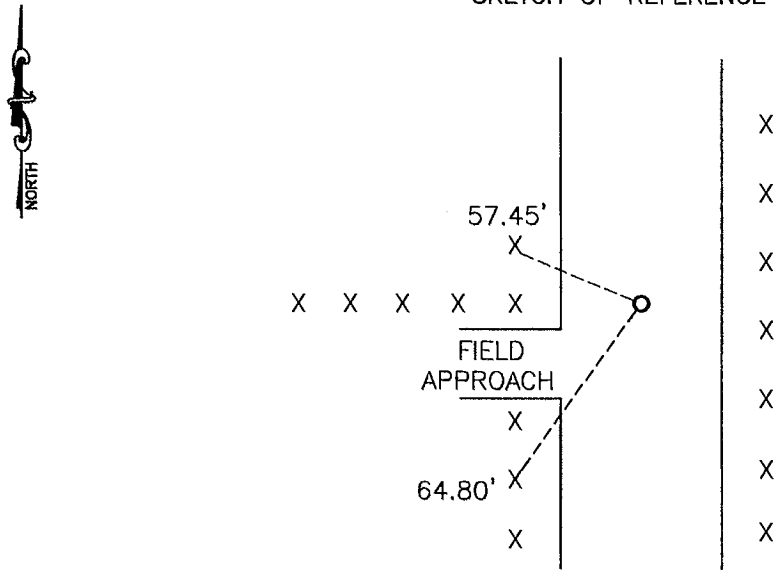

Minnesota State Plane Coordinate
 System Murray County Datum
 NAD83 (1996)
 N: 118937.863
 E: 432127.460

Nail and seal in wooden fence post WNW 57.45'
 Nail and seal in wooden fence post SW 64.80'

Statement of evidence relative to this corner location is on back of page.

I hereby certify that this document and the data contained herein was prepared by me or under my direct supervision.

James V. Johnson 3/5/09
SIGNATURE DATE

Registration No. 43844

Land Surveyor, Professional Engineer
 County Surveyor, County Engineer

OFFICE OF THE COUNTY RECORDER
 County of

I hereby certify that this document was filed in the Co. Recorders office at _____ .M on the _____ day of _____ A.D. 20__

County Recorder *James V. Johnson*
 By _____, Deputy

DOCUMENT NO. JUL 10 2009

Statement of Evidence

In 1866, J. W. Bishop did the original subdivision of the township.

On June 19, 1913, a stone was recorded at the corner.

In 1936, a concrete marker was recorded at the corner.

In 1940, a concrete marker was recorded at the corner.

On October 21, 2008, Bueltel-Moseng Land Surveying dug with a backhoe. We found a 6" round concrete monument with an "X" on top 7" below the road surface. We placed a $\frac{5}{8}$ " iron with seal #43844 on the north and south side of the monument.